

## ASSEMBLY INSTRUCTIONS

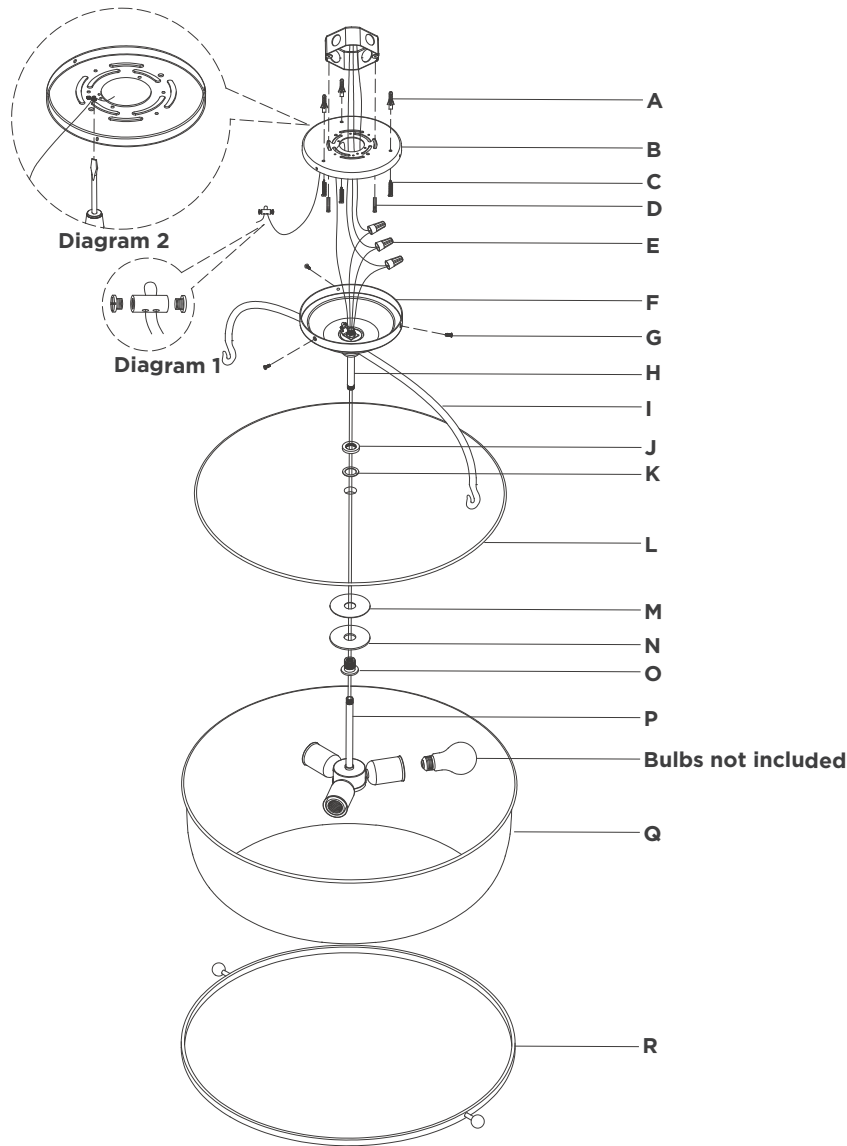

## Lorford Large Semi Flush Lantern

Item # CHC 4272

**WE RECOMMEND INSTALLATION OF THIS LIGHTING FIXTURE BE DONE BY A LICENSED ELECTRICIAN.**

**WARNING\*\*\*SWITCH OFF THE MAIN ELECTRICAL SUPPLY FROM THE MAIN FUSE BOX/CIRCUIT BREAKER BEFORE INSTALLATION.**

**INSPECT ITEM CAREFULLY BEFORE ATTEMPTING TO INSTALL.**

**IF THERE IS ANY DAMAGE OR OBVIOUS DEFECT. DO NOT INSTALL.**

**ITEM MAY NOT BE RETURNED ONCE IT HAS BEEN INSTALLED.**

**NOTE: CAREFULLY UNPACK EACH PIECE IN TOP LAYER OF PACKING PRIOR TO REMOVING. RETAIN ALL PACKING MATERIAL UNTIL INSPECTION AND INSTALLATION ARE FINAL.**

- Carefully remove all parts from the box. Place on a clean, soft surface.
- Remove mounting plate **(B)** from canopy **(F)** by removing screws **(G)**.
- Using mounting plate **(B)** as a guide, line up with the junction box and mark anchor positions.
- Using a drill bit slightly smaller than the anchor, drill holes in the marked positions. Install anchors **(A)** into the holes using a hammer.
- Install mounting plate **(B)** to the junction box and secure with mounting screws **(D)**, then secure wood screws **(C)** to anchors **(A)**.
- Pass fixture wires through connector **(O)**, metal washer **(N)**, rubber washer **(M)**, glass diffuser **(L)**, rubber washer **(K)**, check ring **(J)** and tube **(H)**.
- Thread check ring **(J)** to tube **(H)**, then install rubber washer **(K)**, glass diffuser **(L)**, rubber washer **(M)**, metal washer **(N)** to check ring **(J)** and secure with connector **(O)**.  
**NOTE:** Do not overtighten, otherwise glass could become damaged.
- Thread cluster **(P)** to connector **(O)**.  
**NOTE:** It is recommended to have a helper assist in supporting the fixture for steps 9-14.
- Run support cable through hole on back of mounting plate **(B)**. Loosen cable lock and install to end of support cable. Insert other end of cable through the cable lock and tighten ends with a screwdriver to secure (see diagram 1).

## ASSEMBLY INSTRUCTIONS

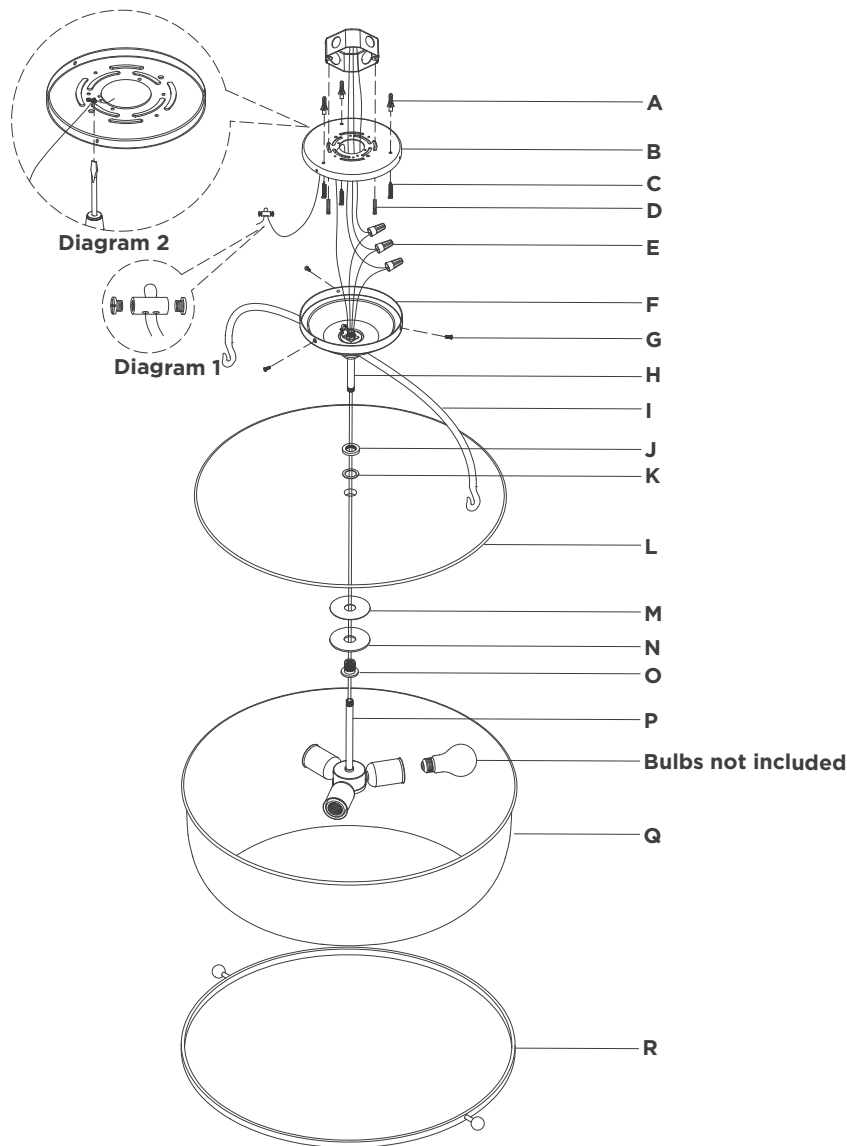

## Lorford Large Semi Flush Lantern

Item # CHC 4272

**WE RECOMMEND INSTALLATION OF THIS LIGHTING FIXTURE BE DONE BY A LICENSED ELECTRICIAN.**

**WARNING\*\*\*SWITCH OFF THE MAIN ELECTRICAL SUPPLY FROM THE MAIN FUSE BOX/CIRCUIT BREAKER BEFORE INSTALLATION.**

**INSPECT ITEM CAREFULLY BEFORE ATTEMPTING TO INSTALL.**

**IF THERE IS ANY DAMAGE OR OBVIOUS DEFECT. DO NOT INSTALL.**

**ITEM MAY NOT BE RETURNED ONCE IT HAS BEEN INSTALLED.**

**NOTE: CAREFULLY UNPACK EACH PIECE IN TOP LAYER OF PACKING PRIOR TO REMOVING. RETAIN ALL PACKING MATERIAL UNTIL INSPECTION AND INSTALLATION ARE FINAL.**

10. Wrap fixture ground wire (bare copper) around the green grounding screw (see diagram 2). Tighten. Continue fixture ground wire and connect to supply ground wire (usually green or bare copper) using wire nut (E).
- NOTE:** It is imperative that the fixture is grounded.
11. Connect fixture neutral wire (white) to the supply neutral wire (usually white) using wire nut (E).
12. Connect fixture hot wire (black) to the supply hot wire (usually black) using wire nut (E).
- CAUTION:** Do not reverse the hot and neutral connections.
13. Make sure all wire connections are tight, then carefully tuck into the junction box.
14. Install canopy (F) to mounting plate (B) and secure with screws (G).
15. Install light bulbs into the sockets.
16. Place glass shade (Q) onto metal ring (R), then hang metal ring (R) to hooks (I).
17. Installation is complete.

\* \* \* Clean with a dry, soft cloth only. Do not use harsh abrasives or chemical agents.

\* \* \* For mercury glass, clean with a feather duster. Wiping with a cloth or cleaning solvents may remove antiquing.