

ASSEMBLY INSTRUCTIONS

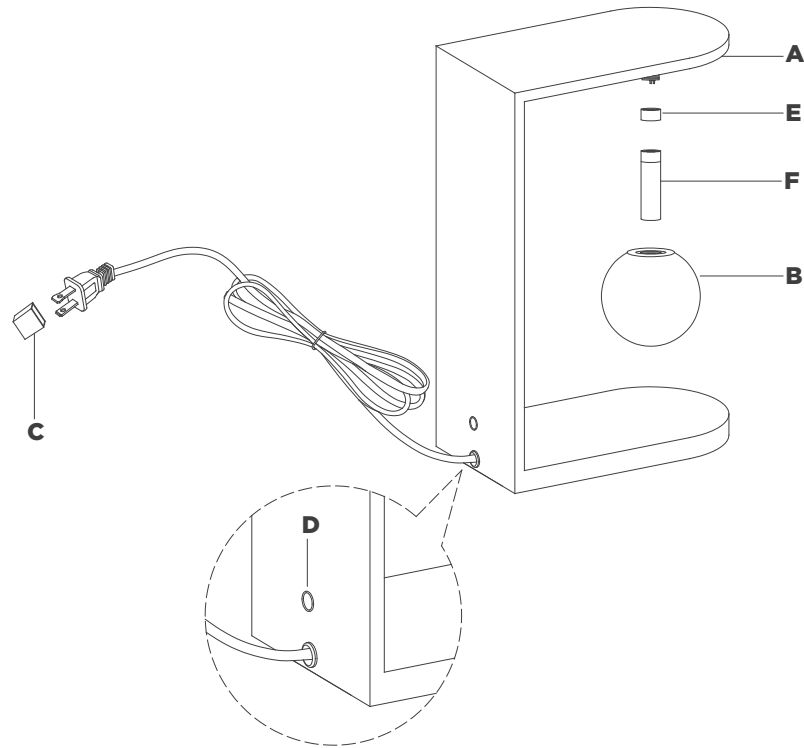

Pertica Small Desk Lamp

Item # KW 3521

NOTICE:

Inspect item carefully before attempting to install. If there is any damage or obvious defect, do not install. Item may not be returned once it has been installed.

1. Carefully remove all parts from the box. Place on a clean, soft surface.
2. Remove protective caps (E) from fixture (A), then thread LED bulbs (F) to fixture (A).
3. Thread shade (B) to fixture (A).

NOTE: Do not overtighten otherwise shade could become damaged.

4. Remove protective cover (C) from plug.
5. Plug into electrical outlet and test the fixture.

Dimmer switch operation: Touch dimmer (D) to adjust between high, medium, low and off settings (See diagram 1).

CARE INSTRUCTIONS: Clean only with a soft dry cloth or feather duster. Do not use abrasive or chemical agents.